

Pegler Valve

DZR ball valve with lockshield. DZR body. Compression ends to EN 1254/2, PN16

PB350LS Ball valve



General Information

Size	Pattern No.	Pack 1 Qty	Pack 2 Qty	Code	Barcode	Price (£) each ex VAT	Discontinued	Date Discontinued
15mm	PB350LS 10	0	0	254220	5022050215192	Disc(Out of Stock)	Discontinued	25/03/2021
22mm	PB350LS 10	0	0	254221	5022050215383	Disc(Stock available)	Discontinued	18/03/2021
28mm	PB350LS 5	0	0	254222	5022050215512	Disc(Stock available)	Discontinued	18/03/2021
35mm	PB350LS 5	0	0	254223	5022050215598	Disc(Stock available)	Discontinued	18/03/2021
42mm	PB350LS 2	0	0	254224	5022050215673	Disc(Stock available)	Discontinued	18/03/2021
54mm	PB350LS 2	0	0	254225	5022050215772	Disc(Stock available)	Discontinued	17/09/2021

PB350LS Ball valve

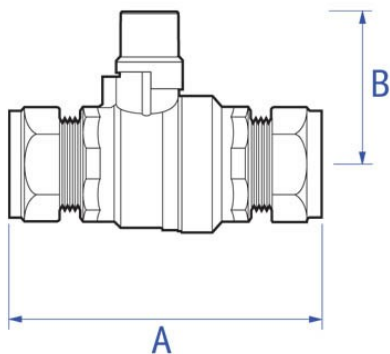

Dimensions

Code Description A B

Pegler Yorkshire reserve the right to change specifications

Flow Rate

Size Pattern No. Code Kv m3/h

Pegler Yorkshire reserve the right to change specifications

Pressure and Temperature

Description	Minimum Operating Pressure (bar)	Maximum Cold Working Pressure (bar)	Maximum Hot Working Pressure (bar)
PB350LS Ball valve	No Minimum Operating Pressure	16.0 bar at temperatures up to 30oC	5.0 bar at temperatures up to 120oC

Materials

Component	Material
Body	DZR brass
Ball	Brass, chrome plated
Stem	Brass
Stem 'O' ring	Viton
Seat rings	PTFE (Teflon)

Component	Material
Lever handle	Steel
Lever nut (self locking)	Zinc plated steel
Tee handle security screw	Nickel plated brass
Lockshield cap	Plastic
Lockshield	Brass
Lockshield security screw	Brass
Compression nut	Brass
Compression cone	Brass
Sleeve	Brass (EL)
Ext Stem	Brass (EL)
Fixing screw	Steel (EL)
Washer	Brass (EL)

Technical Suitability

Steam	Water	Oil	Air	Gas	Inert Gas	Combustible†	Gas Corrosive††	Gas Oxygen
yes	yes	yes	yes	no	no	no	no	no

Pegler Yorkshire reserve the right to change specifications

Gas application guide

Class 1. INERT Air, argon, carbon dioxide, helium, nitrogen

Class 2. COMBUSTIBLE Hydrogen, methane, natural gas, town gas

Class 3. CORROSIVE Chlorine, sulphur dioxide Class 4. OXYGEN

Class 1. INERT Air, argon, carbon dioxide, helium, nitrogen

† Valves are suitable for British Gas Applications Family Gases 1, 2 and 3.

†† Suitable in applications where moisture is completely absent.