

Yorkshire

Straight coupling, copper x copper

YP1 Coupling



General Information

Size	Pattern No.	Pack 1 Qty	Pack 2 Qty	Code	Barcode	Price (£) each ex VAT
6mm	YP1	10	500	08000	5022050080004	£5.60
8mm	YP1	10	500	08001	5022050080011	£5.76
10mm	YP1	10	400	08003	5022050080035	£2.91
15mm	YPS1	10	250	08010	5022050080103	£1.00
22mm	YPS1	10	120	08020	5022050080202	£2.66
28mm	YP1	10	80	08030	5022050080301	£6.15
35mm	YP1	10	40	08032	5022050080325	£20.75
42mm	YP1	2	20	08034	5022050080349	£34.70
54mm	YP1	2	20	08035	5022050080356	£63.98
66.7mm	YP1	1	8	08036	5022050555687	£189.92

YP1 Coupling

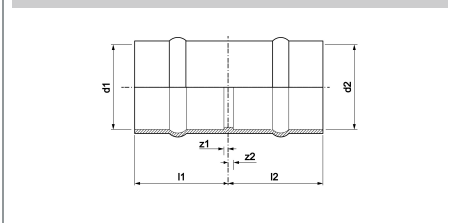

Dimensions

Code Description d1 d2 l1 l2 z1 z2

08000	6mm YP1	6	6	10	10	1	1
08001	8mm YP1	8	8	10	10	1	1
08003	10mm YP1	10	10	11	11	1	1
08010	15mm YP1	15	15	14	14	1	1
08020	22mm YP1	22	22	20	20	2	2
08030	28mm YP1	28	28	23	23	1	1
08032	35mm YP1	35	35	30	30	1	1
08034	42mm YP1	42	42	33	33	1	1
08035	54mm YP1	54	54	39	39	1	1
08036	67mm YP1	67	67	40	40	1	1

Pegler Yorkshire reserve the right to change specifications

Guarantee

Pegler 25 Year Guarantee - Terms and Conditions

Products are subject to a 25 year guarantee that is between Pegler and the final purchaser of the product.

The guarantee is subject to proof of purchase being supplied.

This guarantee does not affect any statutory rights the consumer may have in law.

The guarantee covers manufacturing or material defects when installed in accordance with our instructions on specified tube materials and applications, and does not cover parts subject to normal wear and tear.

This product range has been designed for the use of homeowners, domestic and commercial applications and therefore the Guarantee is subject to the product being properly selected for their intended service conditions.

The guarantee is not applicable where the product is fitted contrary to the conditions in the fitting instructions.

This is reinforced where valves are covered by the European Pressure Equipment Directive (PED97/23/EC) where Installation, Operating and Maintenance Instructions are supplied with each product and/or carton.

Provided it is installed correctly and receives adequate preventative maintenance it should give years of trouble-free service.

Abusive behaviour and accidental damage to the product are not covered by this guarantee.

The extent of this liability is limited to the cost of the replacement of the defective item and not to installation or consequential damages.

Pressure and Temperature

Size	-40°C (Min)	30°C	65°C	110°C (Max)
6mm to 54mm	16 bar	16 bar	10 bar	6 bar
67mm	10 bar	10 bar	6 bar	4 bar

Pressure Loss Tables: Copper Water

Pressure Loss Tables: Copper Compressed Air

Pressure Loss Tables: Copper Gas

Care and Maintenance

Care

No regular aesthetic care is required for this product

Maintenance

No regular maintenance is required for this product.

For any further help please contact the Service Support Team on: 0800 1560050.